

Tivoli

90-foot luxury Doggersbank offshore expedition vessel



Come to *Tivoli* and cruise far beyond the
 [*A world of* horizon of the ordinary.
luxury] Discover a private, floating

kingdom where your wishes are anticipated, your senses indulged. Venture to exotic destinations. Call at fashionable ports. Dine exquisitely. And all the while, savor the pure satisfaction of having chosen a solid, extremely seaworthy, long-range expedition vessel. Accommodating six guests in true graciousness, *Tivoli* carries an experienced, professional crew whose polished and discreet attention will ease you into a relaxation so complete you'll never want to leave.



BOAT INTERNATIONAL MAGAZINE

“OFFERING COMFORT IN STATELY SURROUNDINGS, *TIVOLI* IS WELL-EQUIPPED FOR LONG DISTANCE CRUISING.”





Your ship has come in.

On three deck levels, you'll find ample
 [*Perfection in every detail*] places for stylish
 entertaining, and

intimate spaces for quiet diversion.

A spiral staircase leads gracefully from one to another, while rich mahogany raised paneling and distinctive decor

create an atmosphere of subtle

sophistication. The saloon, with its big couches, Bose entertainment center, bar, and wine cooler, is especially welcoming.

Glass doors lead from here to the covered cockpit, where a settee and easy chairs surround a table just right for breakfast or lunch alfresco. The swim platform and

deck shower are just a few steps away.

Also on this level, a cushioned banquette forward of the wheelhouse is a favorite perch when *Tivoli* is underway.



BOAT INTERNATIONAL MAGAZINE

"...THE AFT DECK IS A GREAT
 WATERSPORTS BASE AND
 OUTDOOR DINING AREA..."





Exquisite style, impeccable taste.



Tivoli's skilled chef, working in the yacht's
 [*Five star cuisine*] professionally equipped galley,
 will prepare each delectable
 meal with care and flair, always following
 your preferences and requests. You and
 your companions will look forward to
 gathering in the handsome dining saloon
 and toasting your good fortune with fine
 wines from the onboard cellar.

Complementing the glow of candle light,
 adjustable lighting controls located
 throughout the yacht will create the
 perfect atmosphere.



BOAT INTERNATIONAL MAGAZINE

“...*TIVOLI*, WITH ITS AMPLE
 BEAM, IS ACTUALLY A MUCH
 LARGER VESSEL THAN ITS
 OVERALL LENGTH MIGHT
 INDICATE.”



Premiere classe *service and surroundings.*

Guest accommodations radiate from a
 [*Privacy in* foyer at the foot of the
elegance] circular staircase.

In all three of the staterooms, you may pre-set your preferred lighting for day, evening, and nighttime; there are individual controls for air conditioning and heat; and the ensuite bathrooms have programmable water-temperature settings and European brass fixtures. Two staterooms are appointed with twin beds, and their bathrooms have enclosed marble showers. The master stateroom features a queen-size bed, settee, dressing table, and two wardrobes. This luxurious retreat also has his-and-her bathrooms, one with marble shower and one with steam shower plus whirlpool.



FORMER GUEST

“TIVOLI MUST BE A TRUE YACHTER’S YACHT. EVERY DETAIL WAS OBVIOUSLY EXTREMELY WELL THOUGHT OUT, FROM THE LAYOUT OF ALL THE SPACES TO THE PERFECTION OF EVERY DETAIL...”





A personal haven *designed to pamper.*

Tivoli's upper deck is also known as the
 [*Your place* spa deck, for it is here that
in the sun] you will find the

large Jacuzzi, workout equipment, and
 broad sunbathing cushions. It's a
 wonderful place for a cocktail party or
 dancing under the stars, with bar,
 barbecue, and music close at hand.

Forward of the spa area, a table and
 curved settee provide yet another spot in
 which to enjoy dining in the balmy air.

Watch from here as the Captain pilots the
 vessel with expertise, or take a seat at the
 bridge for a closer look at the state-of-
 the-art navigational systems.



FORMER GUEST

“I CANNOT THINK OF ANY
 COMFORT OR SAFETY FEATURE
 THAT WAS NOT PROVIDED FOR
 ON *TIVOLI*.”



Where *golden hours* unfold.

You are invited to join *Tivoli* in some of
 [*The world* the most alluring destinations
is yours] on earth. Perhaps it will

be for a captivating tour of Europe's
 storied ports, an interlude among the
 Caribbean's magical bays, or an
 exploration of New England's island-
 dotted waters. With her solid
 construction and proven offshore
 capability, *Tivoli's* cruising grounds are
 truly worldwide. With her devotion to
 elegance and attention to service, her
 comforts are truly world class.



FORMER GUEST

“IT IS EASY TO SEE HOW YOU
 COULD COMFORTABLY SPEND
 THE REST OF YOUR DAYS
 CRUISING THE WORLD IN
 ULTIMATE LUXURY ON *TIVOLI*.”



Distant shores, *exotic memories.*

Tivoli

M/V TIVOLI

90-foot Doggersbank offshore expedition vessel
with worldwide cruising capabilities

Steel hull with aluminum superstructure

Designed by Vripack Yachting International, Sneek, Holland

Built by Proteksan and Turquoise Yachts, Tuzla (Istanbul), Turkey

Commissioned in 2001

[*The best of
everything*]



BOAT INTERNATIONAL MAGAZINE

“DECORATION IS IMPECCABLE,
WITH A LAID TEAK AND HOLLY
FLOOR AND TAN LEATHER
SETTEE ADDING AN AIR OF
SUPERYACHT SOPHISTICATION.”

> Specifications

Length overall	90 feet 6 inches	27.60 meters
Length on waterline	83 feet 4 inches	25.40 meters
Beam	22 feet 9 inches	6.93 meters
Draft	6.6 feet	1.98 meters
Displacement	140 tons	308,560 lbs.
Cruising speed	10 knots at 1,500 r.p.m.	
Maximum speed	12.2 knots at 1,800 r.p.m.	
Cruising range (at 9 knots)	9,000 miles	
Fuel capacity	9,310 gallons	35,244 liters
Water capacity	2,145 gallons	8,120 liters
	Plus 1,500 gallons per day from watermaker	

> Power

- 2 Caterpillar 3406C 300-hp diesel engines
- 2 Northern Lights diesel generator sets of 40-kW each at 1800 r.p.m.
Model M 439D

> Navigation

- Anschuetz gyrocompass and repeater
- Anschuetz digital autopilot
- Rudder-angle indicator
- Raytheon navigational instruments
- Furuno Navtech weather and maritime warning system
- Furuno color depth sounder
- Furuno color Radar with 96-mile range
- Furuno Radar with 72-mile-range
- 2 Furuno D-GPS systems
- Furuno digital compass

> Communications

- Furuno Inmarsat-C SES communications
- Nera Satellite telephone
- Furuno SSB radio, 250-watt
- 2 VHF radios plus handhelds
- Dell PC computer with e-mail access interfaced
with satellite communication
- Satellite radio
- WiFi throughout yacht

> Leisure

- Bose home-theatre sound system in saloon, aft deck, spa deck
- 40-inch flat-screen HD TV/DVDs in saloon and master stateroom
- 475-movie library
- iPod capability throughout yacht
- 1000+ albums available throughout yacht on-line via Sonos

> Comfort

- Air conditioning
- Diesel-fired furnace
- 2 Washers and dryers
- State-of-the-art galley with large refrigerator-freezer
and separate 40-cu. ft. freezer
- Stabilizers

> Recreation

- On-deck Jacuzzi
- Water-skis, slalom skis, children's skis, scurfboard, boogie board, kneeboard
- Biscuit tube
- Fishing tackle
- Snorkeling gear
- SCUBA compressor and 8 tanks (for certified divers only)
- 18-foot Novurania launch with twin 50-hp Yamaha motors
- 13-foot Novurania launch with 50-hp Yamaha motor
- 2 bicycles
- Treadmill
- Barbecue

> Safety

- Global marine distress and safety system
- 2 10-man life rafts
- 2 Handheld radios
- 2 EPIRBs

> Guest accommodations

- Three large staterooms, two with ensuite bathrooms with showers,
and master stateroom with ensuite his and hers bathrooms (one with
whirlpool bath and one with steam shower).

> Crew quarters

- Forward and entirely separate accommodations for 4 crew

UPPER DECK / SPA DECK

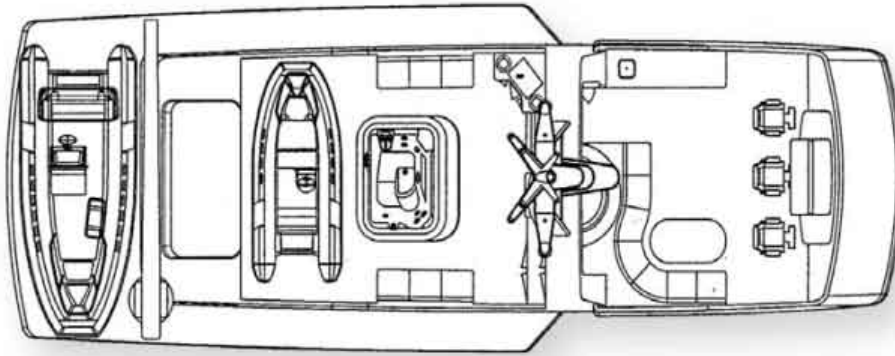

MAIN DECK

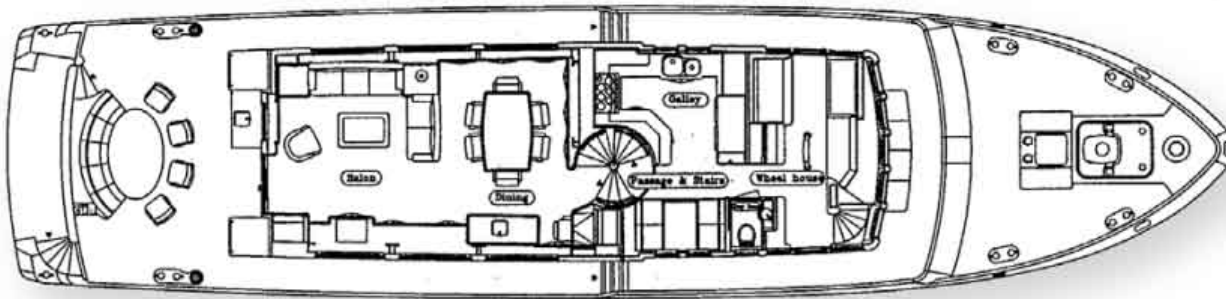

LOWER DECK

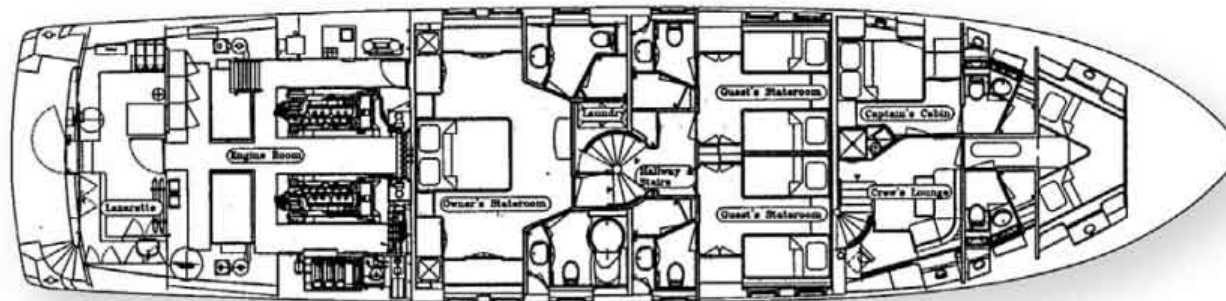

Your private *luxury yacht* awaits.

For more information, please contact:

